

P A R A N J A P E



SUPERLATIVE SENIOR LIVING



This perspective image may not be to the scale or may not represent actual facade / elevation. The details of windows, paints, elevation features, landscaping ground development, trees etc. in this perspective is an artist's impression and would be different to actual construction of building and development. The viewers affirm that he / she has not taken his/ her decision of purchase/booking by viewing this perspective. The company is not responsible for the action of the viewer's booking/ purchasing a unit relying on this perspective.

PROJECT ATHASHRI VADODARA PHASE 2

SPECIFICATIONS

FLOORING AND DADO WORK

- Floor tiles for living, dining, kitchen, bedroom and terrace
- Dado tiles in toilet up to lintel level
- Dado tiles above cooking platform up to lintel level in kitchen

KITCHEN

- Kitchen platform with stainless steel sink

DOORS

- Main and internal doors shutter will be flush door with laminate on both sides
- Powder coated aluminum sliding shutters with glass for terrace doors.
- Sliding / Swing door with vision panel for master toilet.

WINDOWS

- Powder coated aluminum windows with M.S. safety grills.

PAINTINGS AND FINISHES

- Gypsum punning and plastic emulsion paint for all internal walls (except terrace / toilet / utility area).

ELECTRICAL AND PLUMBING

- Concealed wiring with modular switches.
- Concealed plumbing with C.P plumbing fixtures.
- Electrical and plumbing provision for water heater and electrical provision for exhaust fans in all toilets.
- Electrical & plumbing provision for water purifier and electrical provision for exhaust fan in kitchen.
- T.V point in living room and master bedroom.
- Telephone point in living & Master bedroom.
- A.C electrical point in master bed.
- Shower seat in master toilet.
- All toilets with grab bars.

AMENITIES

- Intercom Facility.
- Alarm bell / Panic cord facility in master toilet and panic switch in bedroom.
- Generator backup for lifts water pumps and common lights.
- Doctor's Clinic.
- Guest rooms.
- Resident Manager's office.
- Canteen with dining area.
- Clubhouse with multipurpose hall and gym
- Swimming pool
- Landscape area
- Kids corner.
- Security.
- Ambulance facility



Sr. No.	Area Name
1.	Block A
2.	Block B
3.	Block C
4.	Block D
5.	Dining Area
6.	Club House
7.	Deck and Pool
8.	Temple
9.	Security Cabin
10.	Landscape Area
11.	Kids Corner

2 BHK



1 BHK



BLOCK - 2

GROUND FLOOR PLAN

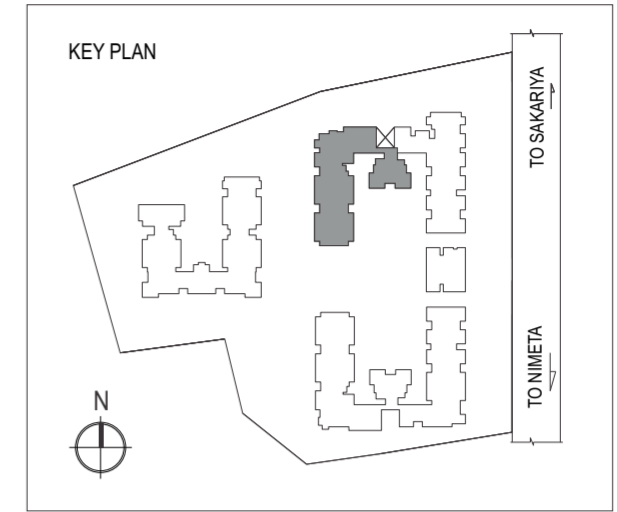

AREA STATEMENT IN SQ.MT

Flat No.	Type	Carpet	Balcony Area	Wash Area	Garden Area
014	2BHK	60.73	3.63	2.20	32.51
015	2BHK	60.73	3.63	2.13	32.51
016	1BHK	44.40	5.05	2.37	20.34
017	2BHK	57.08	2.97	2.52	32.90
018	1BHK	40.10	4.89	0.00	22.20
019	1BHK	39.63	2.83	0.00	27.01
020, 022, 023, 024, 025	1BHK	39.47	2.83	0.00	26.67
021	1BHK	39.58	2.89	0.00	27.26
026, 027	1BHK	39.54	2.82	0.00	27.26
028	GUEST ROOM	20.22	0.00	0.00	0.00

BLOCK - 2

GROUND FLOOR PLAN

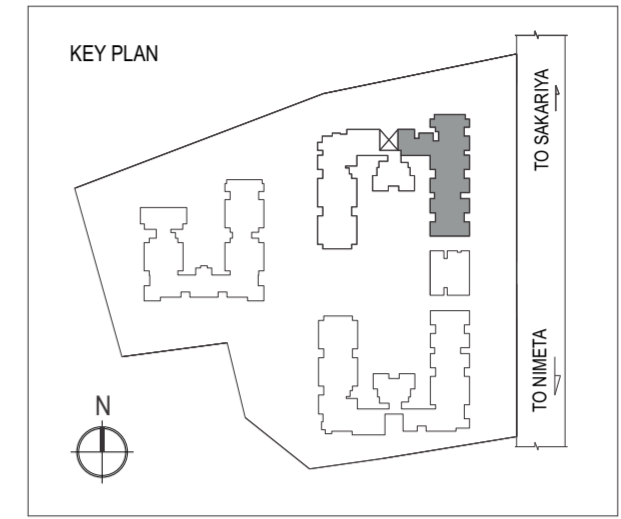

AREA STATEMENT IN SQ.MT

Flat No.	Type	Carpet Area	Balcony Area	Wash Area	Garden Area
001, 002, 003, 004, 005, 006, 008	1BHK	39.63	2.83	0.00	27.01
007	1BHK	39.63	2.83	0.00	26.57
009	1BHK	39.63	2.83	0.00	27.26
010	1BHK	38.51	2.82	0.00	28.08
011	1BHK	38.51	2.82	0.00	16.52
012	1BHK	39.64	2.83	0.00	31.31
013	1BHK	44.33	5.05	2.45	20.34
029	GUEST ROOM	15.05	0.00	0.00	0.00
030	GUEST ROOM	15.95	0.00	0.00	0.00

BLOCK - 2 FIRST FLOOR PLAN

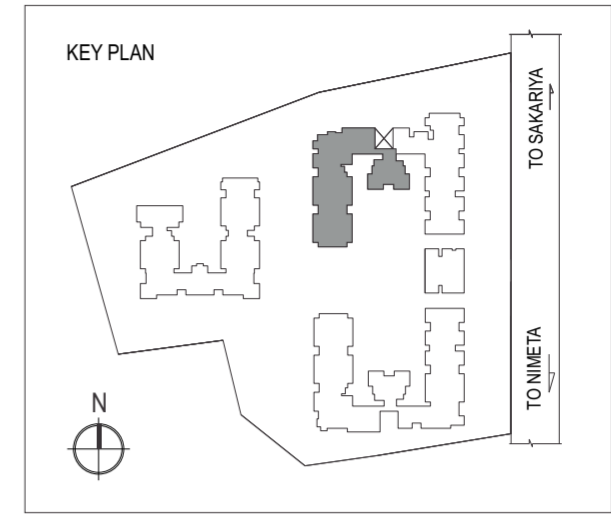

AREA STATEMENT IN SQ.MT

Flat No.	Type	Carpet	Balcony Area	Wash Area
114	2BHK	60.73	3.63	2.20
115	2BHK	60.73	3.63	2.13
116	1BHK	44.40	5.05	2.37
117	2BHK	57.08	2.97	2.52
118	1BHK	40.17	4.89	0.00
119	1BHK	39.63	2.83	0.00
120, 122, 123, 124, 125	1BHK	39.48	2.83	0.00
121	1BHK	39.57	2.89	0.00
126, 127	1BHK	39.53	2.82	0.00
128	GUEST ROOM	20.22	0.00	0.00

BLOCK - 2

FIRST FLOOR PLAN

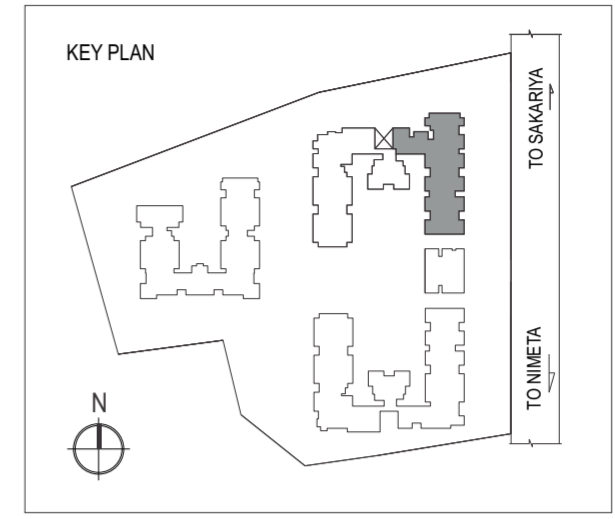

AREA STATEMENT IN SQ.MT

Flat No.	Type	Carpet	Balcony Area	Wash Area
101, 102, 103, 104, 105, 106, 107, 108, 109	1BHK	39.63	2.83	0.00
110, 111	1BHK	38.51	2.82	0.00
112	1BHK	39.64	2.83	0.00
113	1BHK	44.32	5.05	2.45
129	GUEST ROOM	15.05	0.00	0.00
130	GUEST ROOM	15.94	0.00	0.00

BLOCK - 2

2ND, 3RD & 4TH FLOOR PLAN

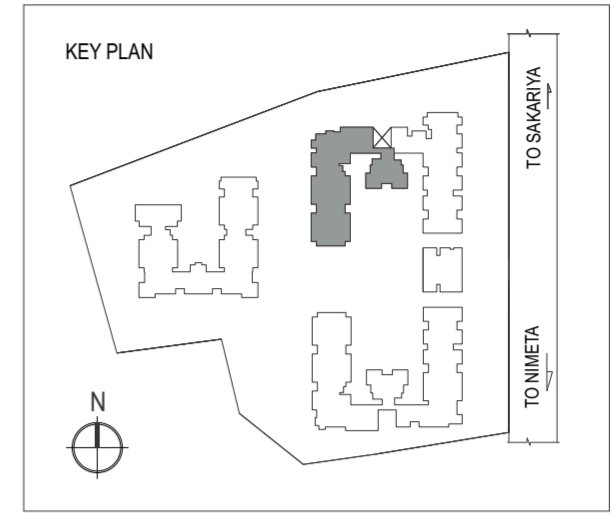

AREA STATEMENT IN SQ.MT

Flat No.	Type	Carpet	Balcony Area	Wash Area
213/313/413	2BHK	65.42	4.51	4.27
214/314/414	2BHK	60.73	3.63	2.20
215/315/415	2BHK	60.73	3.63	2.13
216/316/416	2BHK	65.49	4.51	4.17
217/317/417	2BHK	57.08	2.97	2.52
218/318/418	1BHK	40.17	4.89	0.00
219/319/419	1BHK	39.63	2.83	0.00
220/320/420, 222/322/422, 223/323/423, 224/324/424, 225/325/425	1BHK	39.48	2.83	0.00
221/321/421	1BHK	39.58	2.89	0.00
226/326/426, 227/327/427,	1BHK	39.54	2.82	0.00
228/328/428	GUEST ROOM	20.22	0.00	0.00

BLOCK - 2

2ND, 3RD & 4TH FLOOR PLAN

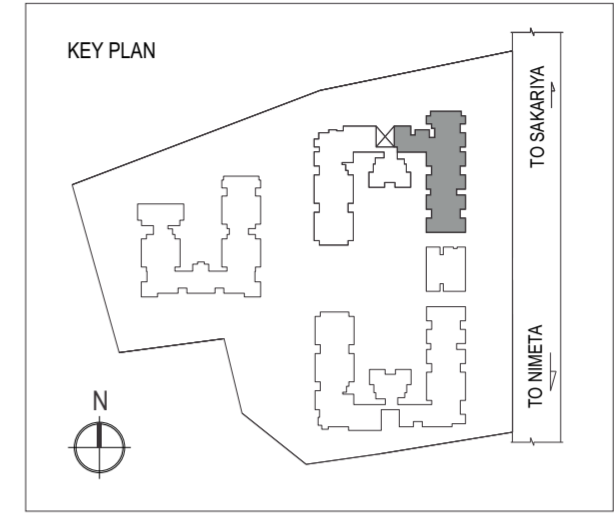

AREA STATEMENT IN SQ.MT

Flat No.	Type	Carpet	Balcony Area	Wash Area
201/301/401, 202/302/402, 203/303/403, 204/304/404, 205/305/405, 206/306/406, 207/307/407, 208/308/408, 209/309/409,	1BHK	39.63	2.83	0.00
210/310/410, 211/311/411	1BHK	38.51	2.82	0.00
212/312/412	1BHK	39.64	2.83	0.00
229/329/429	GUEST ROOM	15.05	0.00	0.00
230/330/430	GUEST ROOM	15.94	0.00	0.00



The Spirit Of New India

Vadodara Office Address: Ground Floor 1 & 2, TAM House, Near Jakat Naka, Chhani Navayard Road, Nizampura,
Vadodara - 390024. Contact: 0265 - 2762244

Paranjape Schemes Projects: Mumbai | Pune | Nashik | Kolhapur | Chiplun | Ratnagiri | Bengaluru | Vadodara
Corporate Office: PSC House, Dr. Ketkar Road, Off Prabhat Road, Pune - 411004.

Contact: +91 20 3939 4949 | www.pscl.in

Mumbai Office Address: Vaibhav Chambers, 1st Floor, Opp. Income Tax Office, Bandra - Kurla Complex, Bandra (East), Mumbai - 400 051

Contact: +91 - 22 - 30659595